



1 LEFT: Exceptional ultra modern free standing homes

 4  4.5  2

OFF PLAN Development. ONE LEFT. 9 on Charles. Located in the sought after boomed and guarded West Hertford enclosure. Minimalistic, leading edge design by SPS arch & design. From R7,945m (no transfer duty) Personal selections on generous finishes. Home from 378m2+. Stand 972m2. Features: Aluminium windows and doors, 2.4m high 3m High shadow line ceilings Frameless shower panels Solar geysers Gas Fireplace SMEG Oven and hob Accommodation: 4 bedrooms ensuite, guest cloakroom, kitchen, scullery, lounge, dining room, pj lounge, covered patio, double/triple garaging. Optional: staff, storeroom, study/5th bedroom ensuite, view balcony and pool. Security: Guarded closed West Hertford enclosure Electric fencing Secure cluster living

Features

Interior

Bedrooms	4	Bathrooms	4.5
Kitchens	1.5	Recep. Rooms	3

Exterior

Garages	2	Security	Yes
Pool	Yes	Views	True

Sizes

Internal	378m ²
External	972m ²

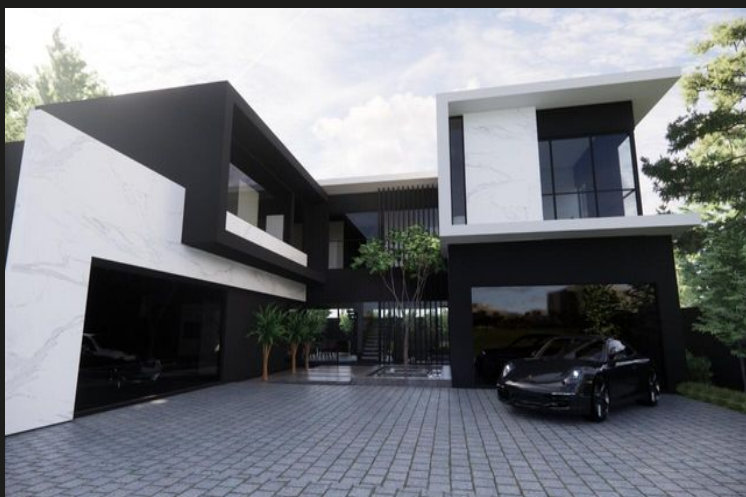

Bryanston at a glance

Bryanston: A Prestigious Suburb Blending Luxury, Convenience & Lifestyle Aerial view of Bryanston from Hamilton's Property Portfolio house Image source: <https://tinyurl.com/5ebbesfe>

Bryanston is a prestigious suburb that combines refined living with everyday convenience. It's proliferation of trees contribute to Johannesburg's accolade of being recognised as the biggest urban forest in the world. Close to Sandton and areas like Sandhurst and Fourways, it offers a unique mix of elegant homes, robust community infrastructure and excellent amenities - all of which appeal to homeowners, families and investors alike. Its strategic location, proximity to top schools, reliable healthcare facilities and efficient transport links further...

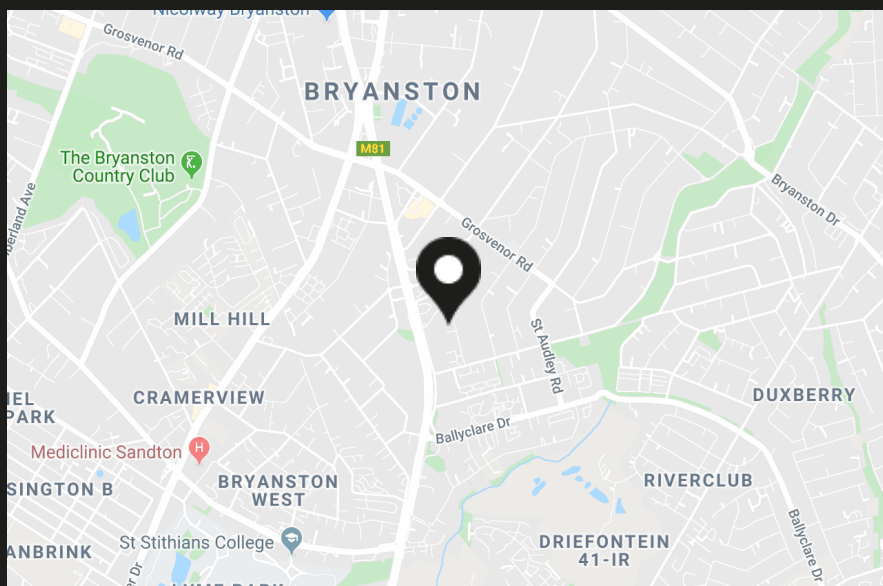

Alison Stroobach
Property Practitioner



0829236501



alison@hamiltons.co.za



Peter Stroobach
Property Practitioner



0832572374



peter@hamiltons.co.za